

STEWART FILMSCREEN – Installing IMC

Document Identifier	Revision	Date Approved	Date Effective
QW-757	A	2-2-22	2-3-22
Responsibility and authority:	Process Owner		Position / Title
	Dino von Noy		QA Manager

1.0 PURPOSE:

To Safely and correctly Install IMC Low Voltage Screen Control

2.0 Scope:

This procedure applies to understanding the IMC.

3.0 Definitions:

120 VDC – 120 Volts Direct Current

4.0 Reference Documents, Disclaimer:

Attention: All electrical connections must conform to local and NEC codes. Stewart Filmscreen cannot be held liable for faulty or sub-standard wiring.

5.0 Procedures:

The IMC is a low voltage screen control that allows for switching conductors to be run in Class II (small wire, exposed, no conduit) and will interface with outboard video switching systems. The IMC has the capability of being operated through a wall switch, infrared remote, radio frequency remote, internet protocol (IP) control system, and a screen trigger through a projector. For a detailed look at what the IMC has on board, please see page 2.

The IMC has the capability of being operated through a wall switch, infrared remote, remote, internet protocol (IP) control system (requires optional e-Node), Serial RS 232, (requires optional IBT-100) and a screen trigger through a projector.

The IMC comes prewired from the factory to the motor and to the power cable. For your reference, in the case of servicing, we broke down the pin layout for the high voltage side of the connections. Always have a qualified electrician handle high voltage connections.

AC load side	IMC 100	Motor Power Connections
BLACK	Pin 1	AC Line +
WHITE	Pin 2	AC Neutral
NC	Pin3	Motor BLACK Line
NC	Pin 4	Motor Neutral
GREEN	Pin 5	Connect Ground to "Grounding" lug on IMC housing. Also connect ground wire from motor housing to same lug

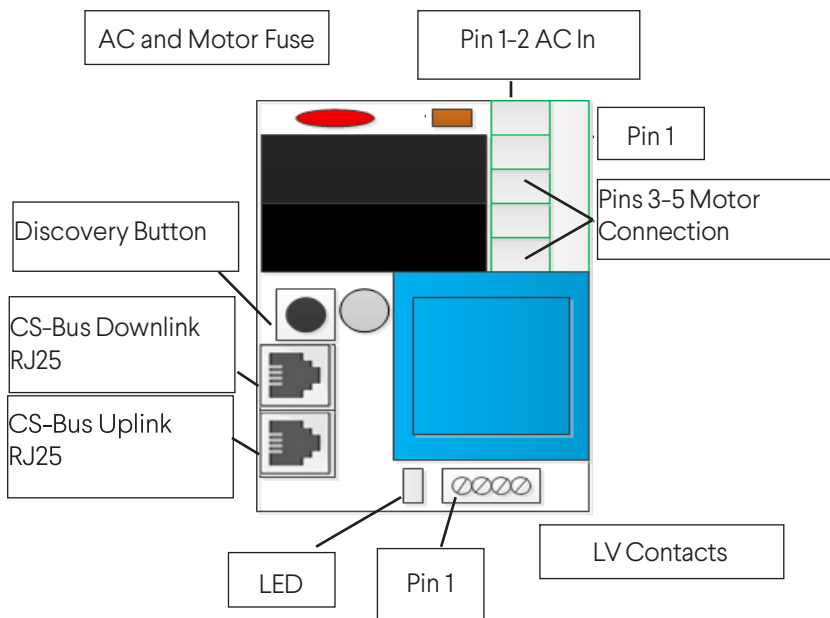

IMC Control Board Schematic

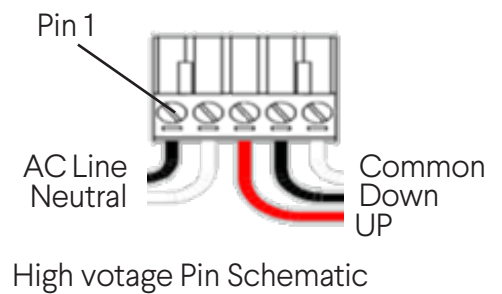

LVC Contacts	IMC 100	COMMANDS
COMMON	Pin 1	COMMON
CHANNEL 1 INPUT	Pin 2	UP
CHANNEL 2 INPUT	Pin 3	DOWN
SCREEN TRIGGER INPUT	Pin 4	TRIGGER 3-15 VDC w/ COMMON

IMC Wiring Diagram

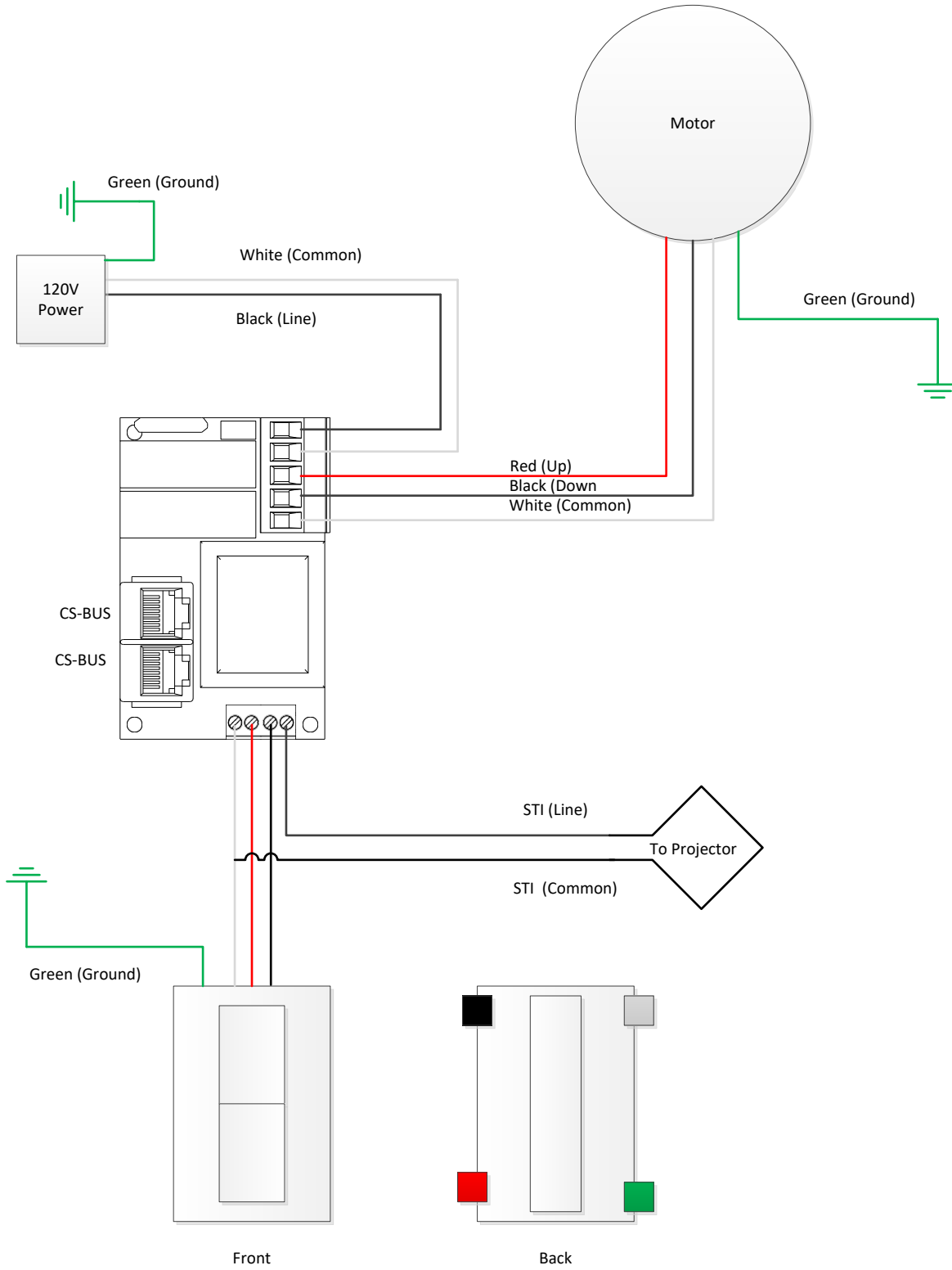

Luxus G2

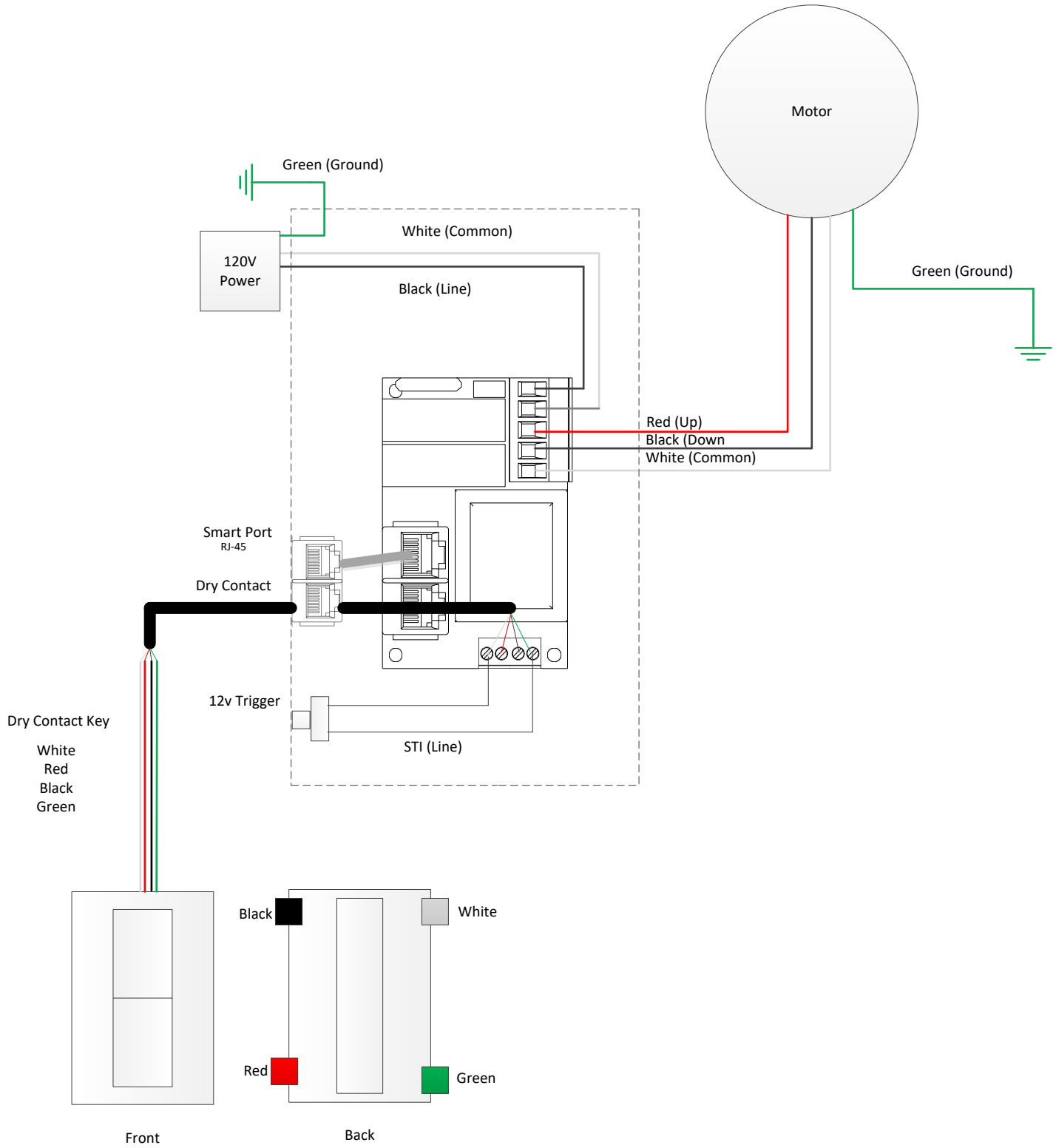

IMC with e-Node

